

FPL Easement Portion of North Perry Airport

Facts	General Information
Site Ownership:	Broward County
Site Location:	7201 South Airport Road, Pembroke Pines, FL 33023
Folio Number	514115060010
Easement Size:	Approximately 2,534.3 square feet.
How Acquired:	Quit Claim Deed dated April 18 th , 2019, and recorded on June 12, 2019 in Instrument 115864953, of the Official Records of Broward County.
Zoning in Area:	A - Airport
Land Use:	70 - Transportation
Property Assessed Value:	\$22,129,840.00
Legal Description:	NORTH PERRY AIRPORT 113-30 B TRACT A LESS PT DESC IN OR 14127/765 & LESS PT DESC'D IN PARCEL 105 OF CA 92-15786 & LESS PT DESC AS COMM AT NW COR OF SW1/4 SEC 15, SLY 95 TO POB,S 420

Aerial Photo of Site:

Property Id: 514115060010

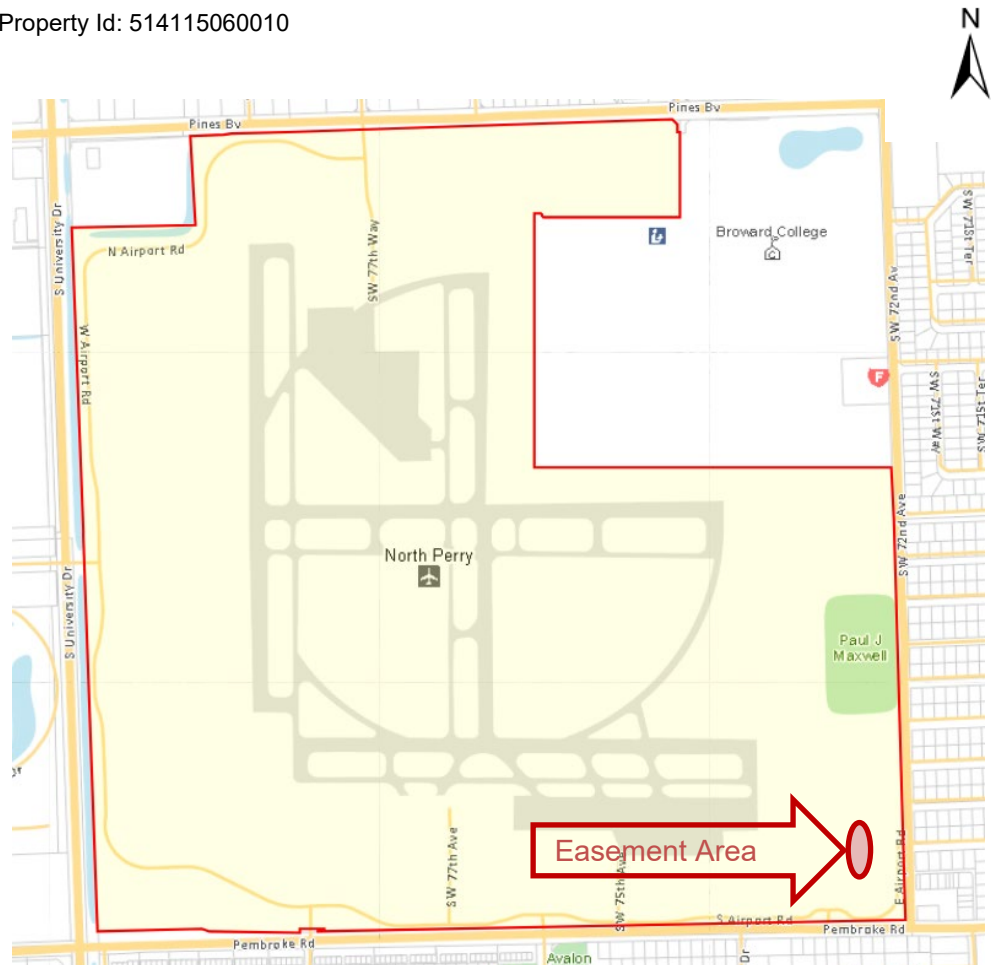

Facts

General Information

Aerial Easement Overlay:

**10' FPL Easement.
Approximate 2,534.3' SF**

