

County Owned Right of Way Eisenhower Boulevard – City of Fort Lauderdale

Facts	General Information
Site Ownership:	Broward County
Site Location:	The subject property is on Eisenhower Boulevard in between SE 17 th St CSWY and where SE 24 th Street meets Access Road.
Folio Number:	504214360010
Parcel Size:	Approximately 3,749,874 SF
Commission District:	4
Zoning in Area:	PEDD Port Everglades Development District
Land Use:	1 – Water
Legal Description:	PORT EVERGLADES PLAT NO 2 108-31 B PARCEL A LESS POR DESC:COMM SW COR OF NE1/4 OF SE1/4 OF SEC 14-50-42,NLY 289,ELY 95 TO POB, ELY 220,NLY 792,WLY 220,SLY 411, WLY 15,SLY 110,ELY 15,SLY 271 TO POB,& LESS POR PAR A DESC AS COM NW COR PAR A,E 80 TO POB,CONT E 832,S 288.81,W 114.03,N 88.96,W 475.01,N 29.73,W 235,N 168.61 TO POB

Aerial Photo of Site:

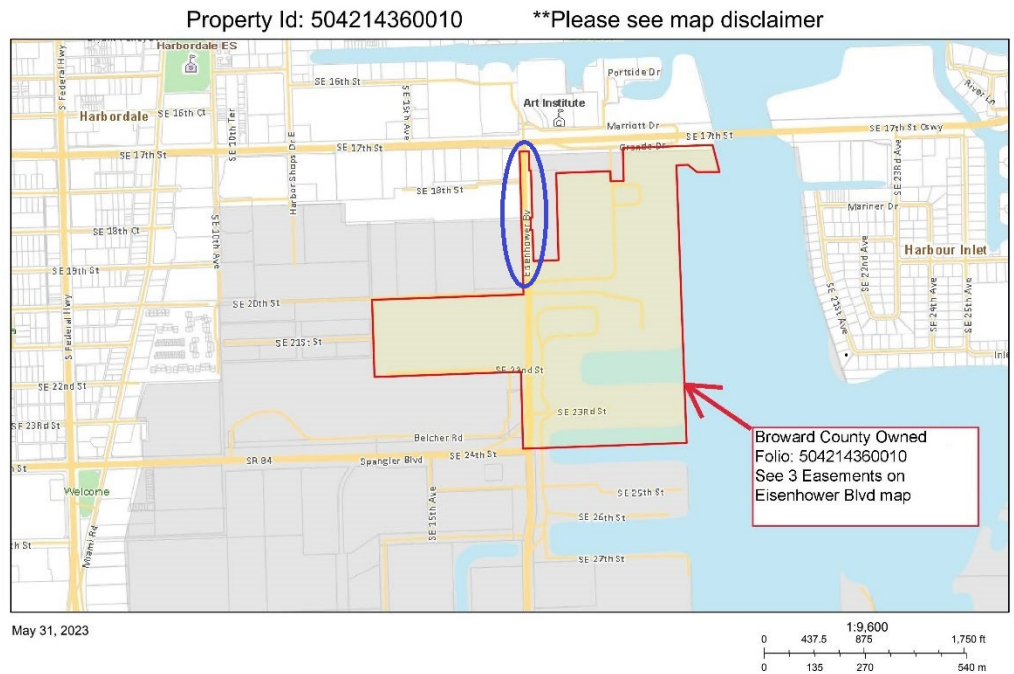

Folio 504214360010

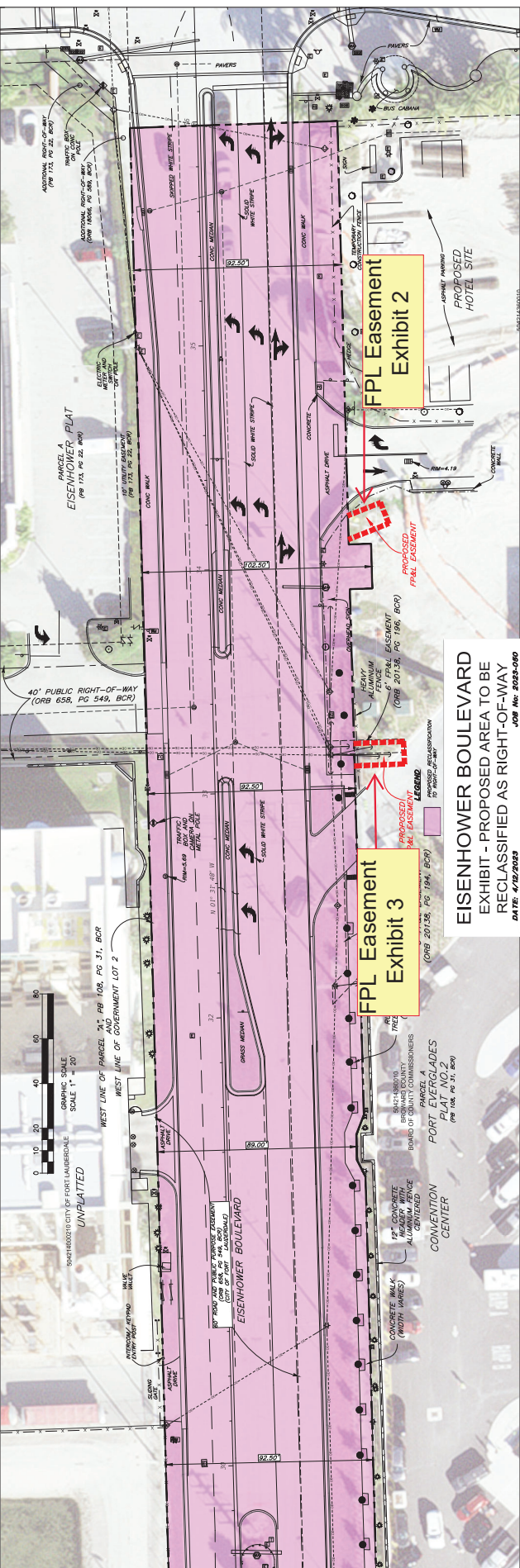
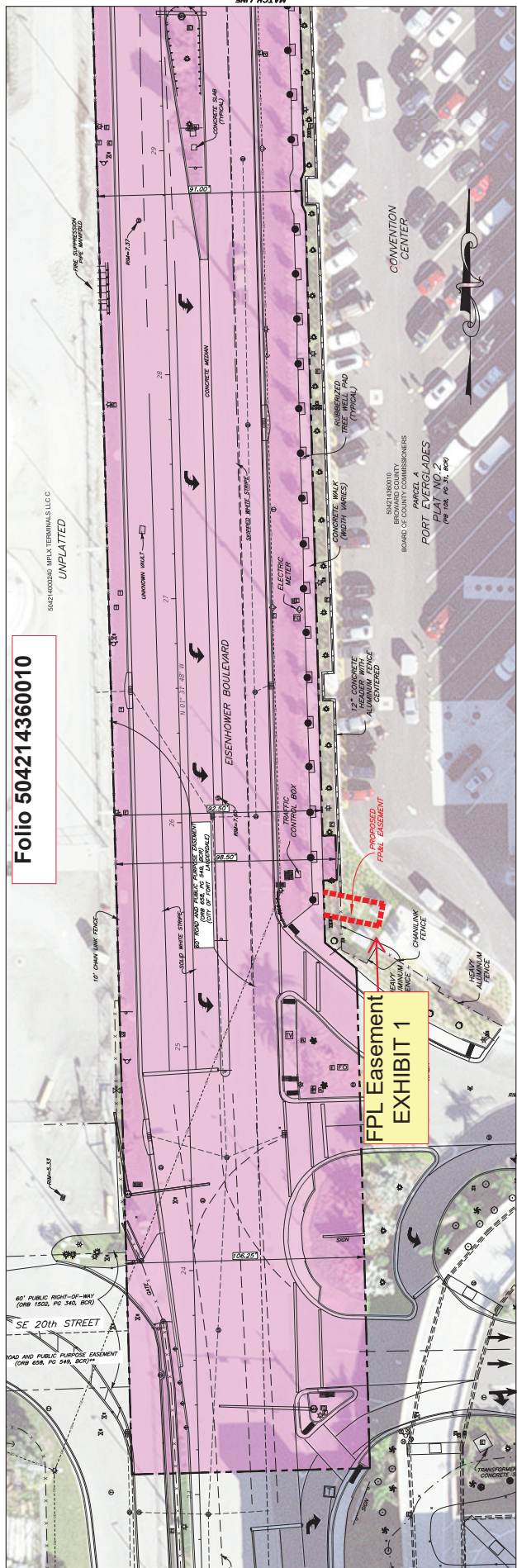

EISENHOWER BOULEVARD
EXHIBIT - PROPOSED AREA TO BE
RECLASSIFIED AS RIGHT-OF-WAY
DATE: 4/29/2023
JOB NO. 2023-000